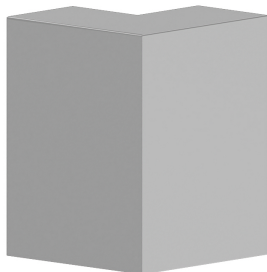

Date: 24.03.2023

Outer corner BRS 80x200/80, steel, zinc

**Product description**

Outer corner as cut-covering moulded hood for wall duct made of sheet steel, for routing cables around wall projections, with pre-assembled cover for plugging into the bases, side length 170 mm.

Basic data

Item number	12868
Product group	20-Wall installation
Packing unit	1 piece
EAN code	4018475275249
Tariff number	73089059

Technical features

Width	200 mm
Depth	80 mm
Number of covers	1
Cover width 1	80 mm
Symmetric	yes
Model	moulded hood
Angle	90 - 90 °
Material	steel
Halogen free	yes
Surface protection	pre-galvanised
Colour	other
Mounting method cover	inner lying