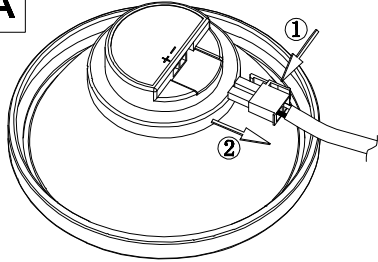
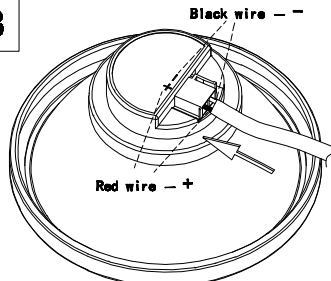
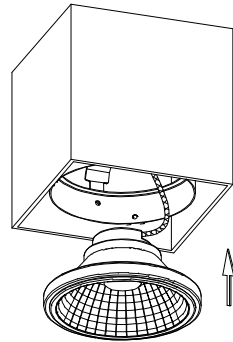
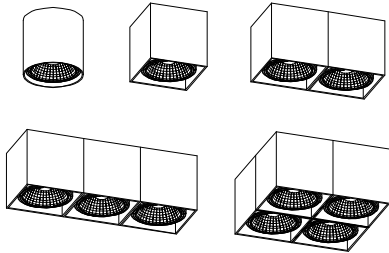
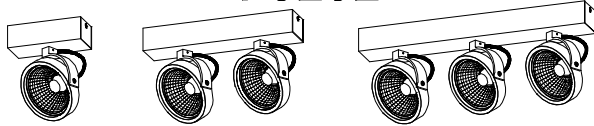

A

Press the plastic buckle with your hand and pull the plug out

B

The red line facing the "+" and the black line facing "-"
Then plug the plug into the new light source

BOX**PULSE**

Note: When replacing the light source, remove the rear cover and magnet and save them, after replacing the new light source, install the magnet and rear cover according to the instruction manual

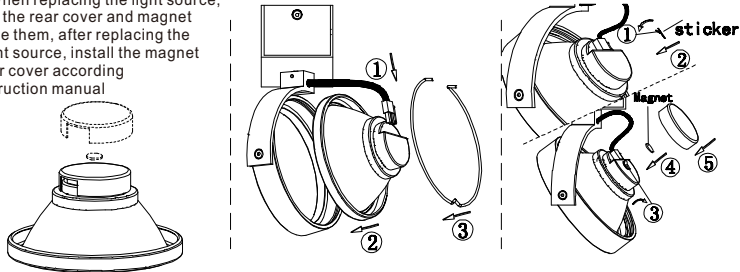
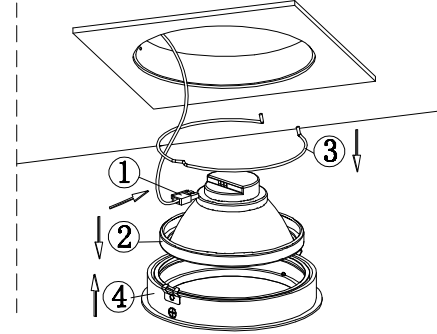
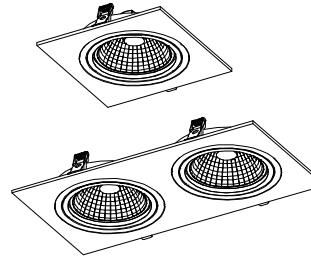
**ZOOM-LARGE****AEON**