

SQUBE ON TRACK

20-04-2018

1.0 LED

LED 6W | 220-240VAC | 50-60Hz | COB3-step | incl. PS | phase-cut dim

CE \oplus \wedge 38° IP20 \square 960°C \perp 0.3m \oplus \updownarrow 90° \curvearrowright 355°

white texture	144164W
black texture	144164B

LIGHT COLOUR

2700K >80CRI 350lm	2
3000K >80CRI 380lm	4
1800-3000K >80CRI 350lm	9

1-phase track accessories on second page

1.0 PAR16

PAR16 max. 35W | GU10 | 100-240VAC | 50-60Hz

CE \oplus IP20 \square 960°C \perp 0.9m \oplus \updownarrow 90° \curvearrowright 355°

white texture	144120W0
black texture	144120B0

OPTIONAL

for PAR16 lamps see our catalogue
1-phase track accessories on second page

④

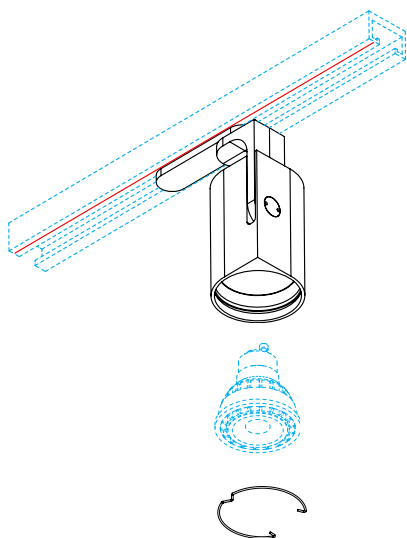

①

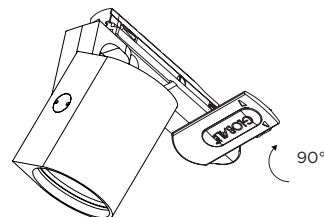

②



SAFETY ISSUE!
INSTALL THE FIXTURE
CORRECTLY ON THE TRACK
(see remark 2)

③

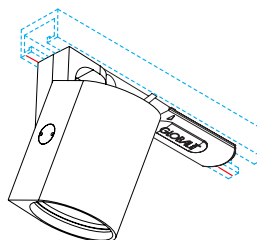

DIMENSIONS

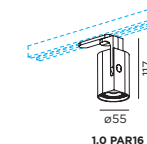
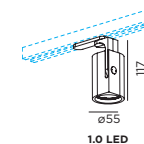

MOUNTING INSTRUCTION

- ① Turn the handle, which is mounted on the fixture, 90°.
- ② Push the fixture into the track. Make sure the \oplus icon on the inside of the adaptor is faced towards the track side with the small line craved in it. (marked red in the drawing)



Make sure the handle is turned 90° when inserting the adapter into the track.

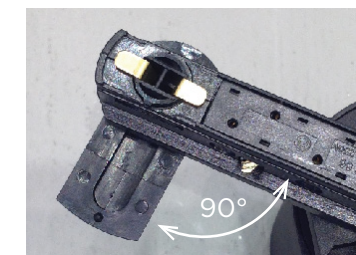

- ③ Turn the handle back into the original position.
- ④ For PAR16: mount the lamp into the fixture



WEVER & DUCRÉ
LIGHTING

www.weverducre.com

INSTALLATION
INSTRUCTIONS

PAGE 1/2

SQUBE ON TRACK

ACCESSORIES

TRACK PROFILE 1m | 1-phase

white 90014001
black 90014007



TRACK PROFILE 2m | 1-phase

white 90014002
black 90014008



TRACK PROFILE 3m | 1-phase

white 90014003
black 90014009



END FEED left

white 90014018
black 90014019



END FEED right

white 90014020
black 90014021

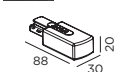

MIDDLE FEED

white 90014036
black 90014037

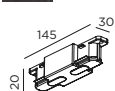

CONNECTOR straight

white 90014022
black 90014023



L-CONNECTOR left

white 90014024
black 90014025



L-CONNECTOR right

white 90014026
black 90014027



END CAP

white 90014028
black 90014029

